

BSA Road Ceramic Aero UAE
Bottom Bracket for 24mm

35010417101603

Before installation

Use the tools recommended in this manual.
Do not modify the product in any way that could pose a risk to the rider or to other people.
Any modification to the product will void the warranty.
If in doubt, consult your authorized Bikone dealer/workshop or download it from:
<https://www.bikone.com/downloads/>

During use

Check that there is no lateral movement in the crank arms and that they rotate smoothly.
Make sure the crank arms are correctly adjusted and tightened to the torque recommended by the manufacturer.
Do not use brake cleaner to clean the components, or any other products that may corrode the materials.

Installation

Attention! Check your frame

Some frames may have screws in the central area or steps that prevent internal installation. In the case of screws, they must be replaced with shorter ones.

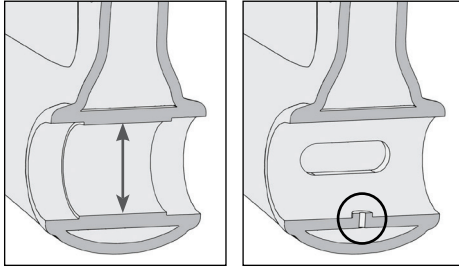

Assembly tool (included with the product):

Left side: BSA Aero-specific assembly tool or any "square taper" bottom bracket tool that can be inserted from inside the frame.

Right side: Any standard tool for Ø44 mm outer diameter and Ø42.7 mm inner diameter. 16-notch.

We recommend any standard assembly grease, such as:
FinishLine Premium Grease / Park Tool PPL-1 Polylube 1000 / Mobil 1 Synthetic Grease / Muc-Off Biological Grease / others.

Do not use carbon assembly paste under any circumstances.

01 - Assemble the left-side tool

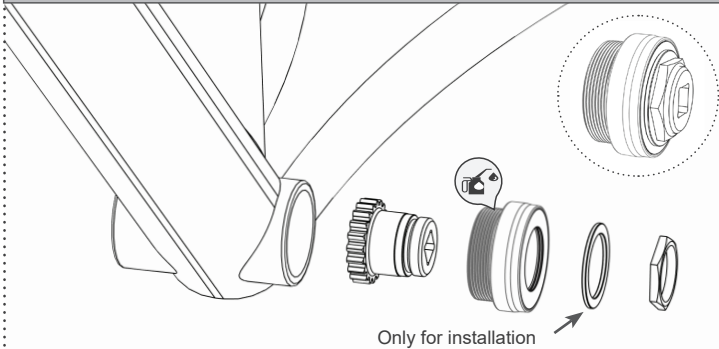

Grease the contact area with the frame.
Assemble the internal tool, ensuring the internal pins engage correctly. Use the nut and washer to secure the tool safely during installation.

02 - Install the left side

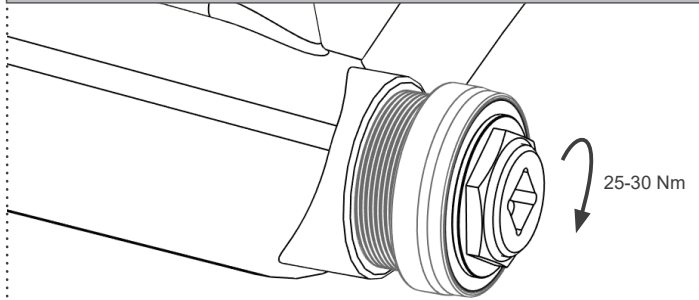

Install the left side. Use a 3/8" wrench and apply 25–30 Nm.

03 - Install the right side

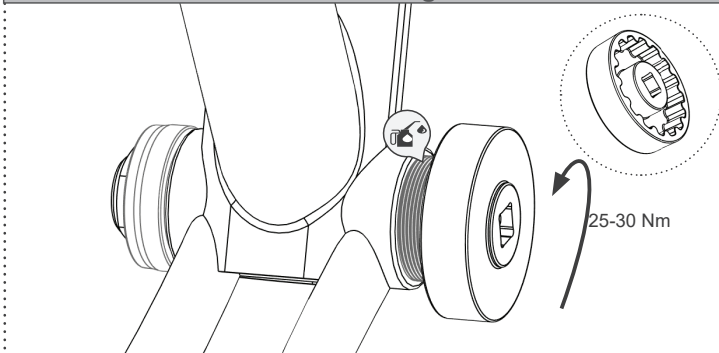

Grease the contact area with the frame.
Install the right side. Using the assembly tool, use a 3/8" wrench and apply 25–30 Nm.

04 - Install the crank arms

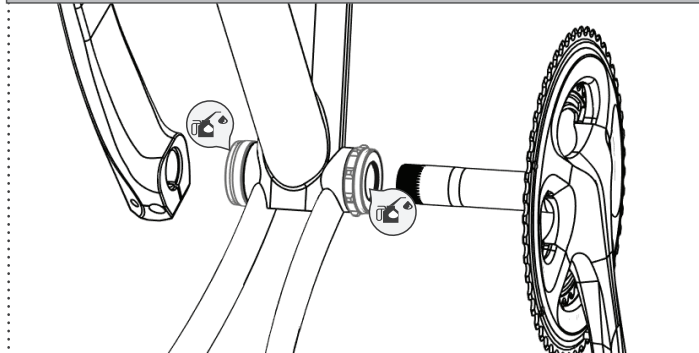

Grease and install the crank arms following the manufacturer's assembly steps.
Note: grease the bore/hole, not the crank axle/spindle. The O-rings would push the assembly grease toward the outside of the bottom bracket axle.

Disassembly

Required tools

Left side: BSA Aero-specific assembly tool or any "square taper" bottom bracket tool that can be inserted from inside the frame.
 Right side: Any standard tool for $\varnothing 44$ mm outer diameter and $\varnothing 42.7$ mm inner diameter. 16-notch.

Left-side tool

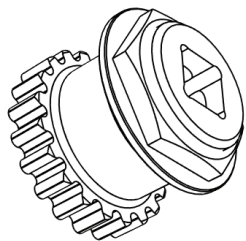

Right-side tool

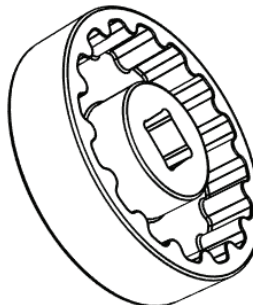

01 - Remove the crank arms

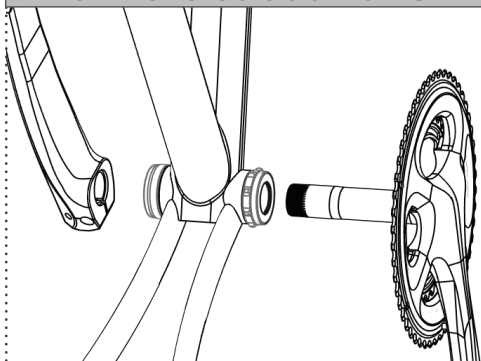

Remove the crank arms

02 - Loosen the right side (R)

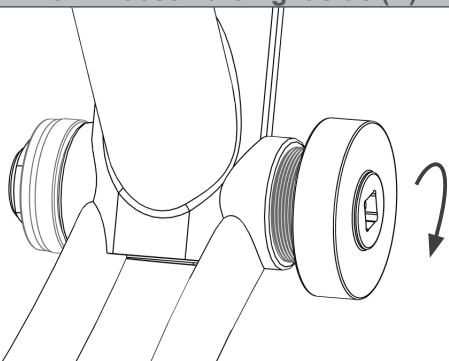

Using the tool, loosen the right cup first.

02 - Loosen the left side (L)

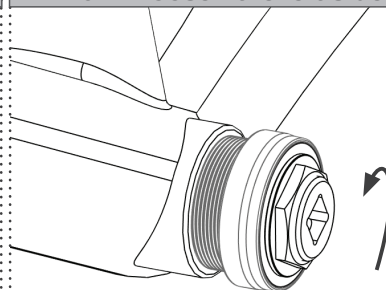

Loosen the left side.

Warranty

All Bikone bottom brackets are warranted against product defects for 3 years from the date of purchase.
 This warranty applies to the original purchaser and is not transferable to future owners.
 The warranty does not cover damage caused by normal wear on consumable parts.
 The warranty does not cover damage caused by improper installation.
 Please visit our website for more information or contact an authorized dealer.