

Assembly instructions for
DCTech - ITA

DCTech ITA_30
DCTech ITA_24 | DCTech ITA_29

Before installing

Use the tools recommended in this manual.
Do not alter the product in any way that may cause risk to the rider or others.
Any modification to the product will void the warranty.
In case of doubt consult your authorised bikone workshop or get in contact with
customer.support@bikone.com

During use

Check that there is no lateral movement in the crankset and turn smoothly.
Make sure that the cranks are correctly adjusted and tightened to the torque specified by the manufacturer.
Never clean the bottom bracket with direct water pressure or brake cleaning liquid.
A soft brush or wet cloth and soap is recommended.

Installation

Attention! Check your frame

Some frames may have screws in the middle and need to be replaced by shorter ones or steps blocking the interior installation.

Dimensional info at:
<https://www.bikone.com/downloads/>

Assembly tools:

ITA for Shimano. Bikone Tool BSA/ITA Shimano, Parktool BBT-69.3, Shimano TL-FC32 or similar: Ø44 mm on the outside and Ø42.7 mm on the inside. 16 notch.

ITA for Sram Dub / BB30: Bikone Tool BSA/ITA Sram Dub/ BB30. Any BSA tool with 24 or 12 notch. Ø45,5 mm on the outside and Ø44 mm on the inside.

Greases non drive side (L): FinishLine Premium Grease / ParkTool PPL-1 Polylube 1000 / Muc-Off Bio Grease / Others

Threadlock drive side (R): Threadlock low intensity: LOCTITE 222.

Do not use carbon paste or brake cleaner under any circumstances.

01 - Greasing of surfaces

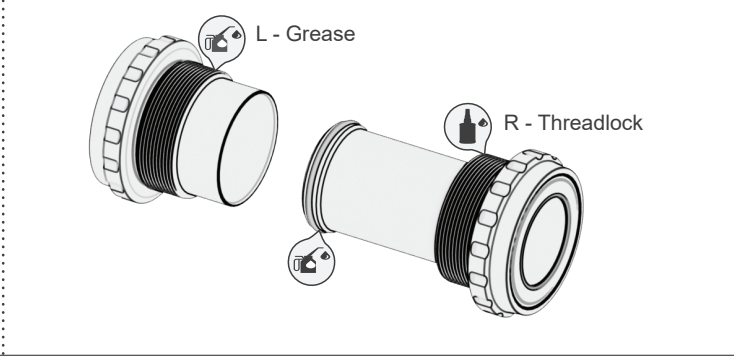

Left side: Installation grease
Right side: low intensity Threadlock; Ej: LOCTITE 222

02 - Cup threading

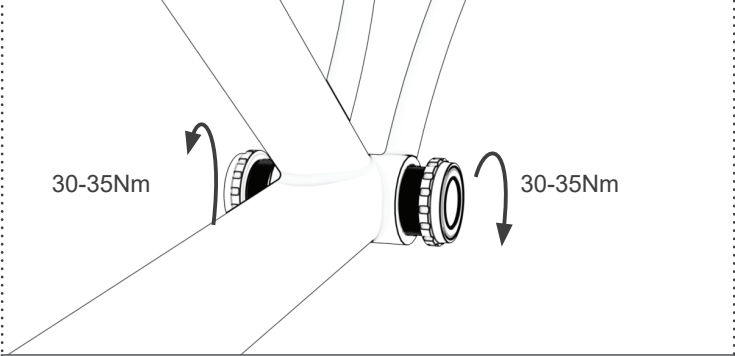

Tight both cups by hand or with the help of the 'assembly tool', preferably at the same time so that the DCTech system aligns the BB correctly.
Once both cups are tightened to the frame, tighten to the specified torque.

03 - Install spacers or O-rings

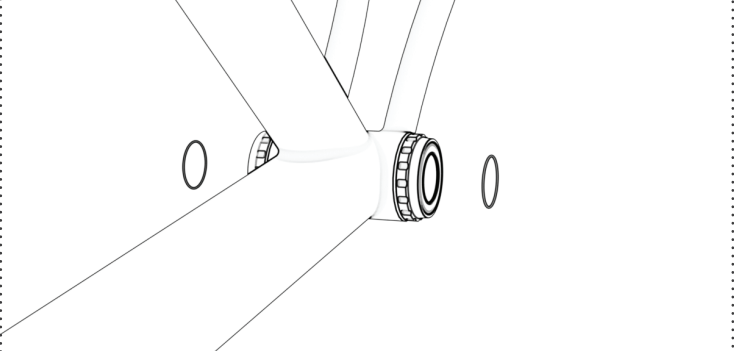

Install spacers or O-rings depending on model,
See specifications on: <https://www.bikone.com/downloads/>

04 - Install connecting rods

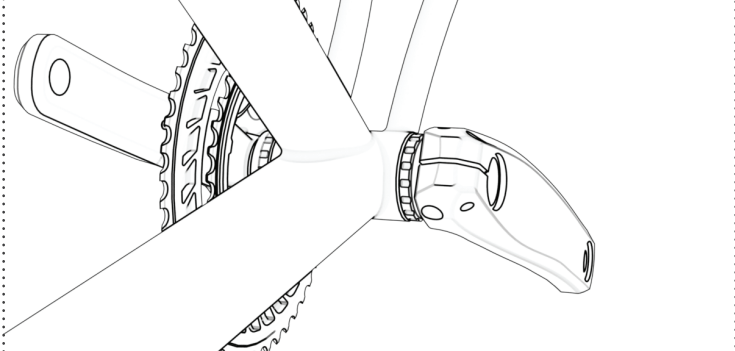

Grease and install crankset following the manufacturer's assembly steps.

Dissassembly

Disassembly Tools

ITA for Shimano. Bikone Tool BSA/ITA Shimano, Parktool BBT-69.3, Shimano TL-FC32 or similar: Ø44 mm on the outside and Ø42.7 mm on the inside. 16 notch.

ITA for Sram Dub / BB30: Bikone Tool BSA/ITA Sram Dub/ BB30. Any BSA tool with 24 or 12 notch. Ø45,5 mm on the outside and Ø44 mm on the inside.

01 - Remove the crankset

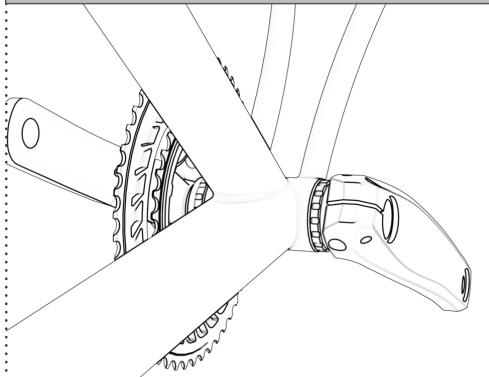

Remove the crankset

02 - Release cups

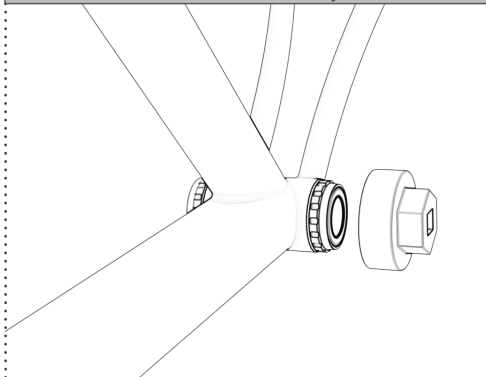

With the help of your tool, untighten by applying the required torque in the direction of rotation indicated on the cup.

03 - Unscrew the cups

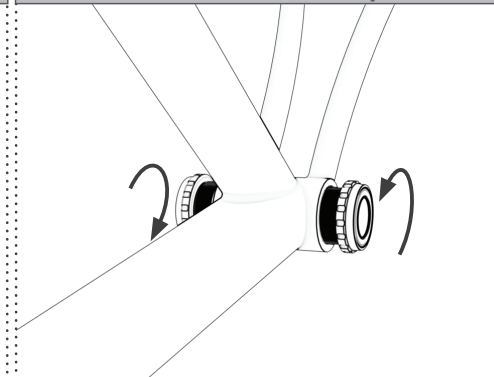

With the help of the tool, loosen in the opposite direction of rotation indicated on the cup.

Warranty

Bottom bracket cups have a lifetime warranty. Bearings are warranted for 3 years.
 This warranty applies to the original owner of purchase and is not transferable to future owners.
 The warranty does not cover damage caused by use on wear parts.
 The warranty does not cover damage caused by improper installation.
 Please refer to our website for more information or visit an authorised dealer.

Learn more at: <https://www.bikone.com/warranty-terms-conditions/>